

**DETAIL A
ROAD BUILD-UP**

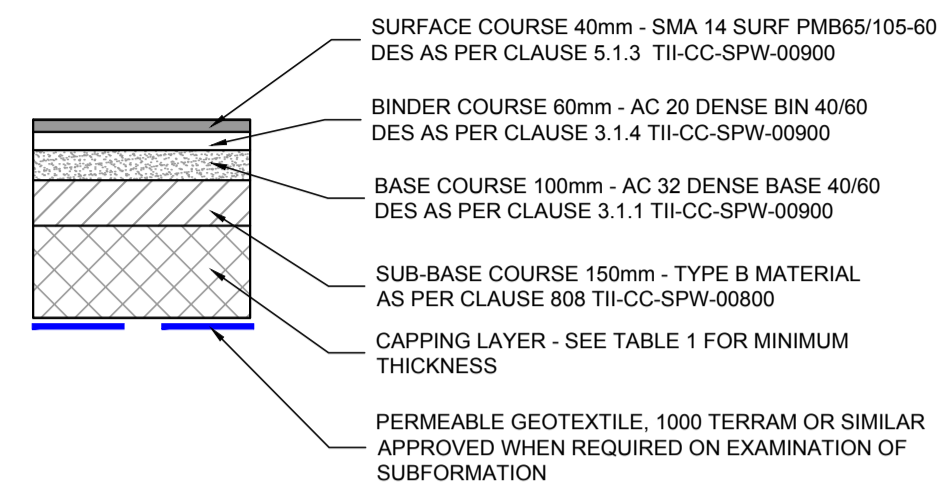

**DETAIL B
PERVIOUS PAVING BUILD-UP**

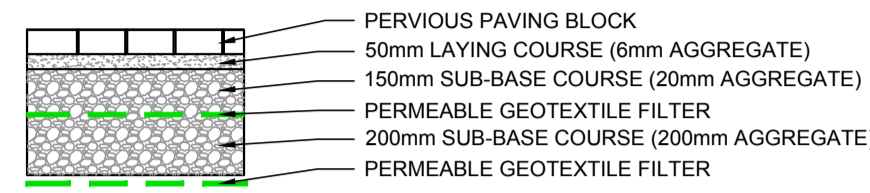

NOTES:

- DO NOT SCALE FROM THIS DRAWING USE STATED DIMENSIONS ONLY. IF IN DOUBT CONSULT THE ENGINEER.
- ALL ROAD WORKS SHALL COMPLY WITH THE ENGINEERS SPECIFICATION AND THE TRANSPORT INFRASTRUCTURE IRELAND SPECIFICATION FOR ROADWORKS.
- TRAFFIC MANAGEMENT SHALL AT A MINIMUM COMPLY WITH DTTAS TRAFFIC SIGNS MANUAL AND THE REQUIREMENTS OF THE RELEVANT LOCAL AUTHORITY, AND BE IN ACCORDANCE WITH THE CONTRACT.
- THIS DRAWING SHALL BE READ IN CONJUNCTION WITH THE SPECIFICATION.
- FOR ROAD LEVELS REFER TO DRAWING N251-C01 & N251-C02.
- FOR PERVIOUS PAVING DETAILS REFER TO DRAWING N251-H05.
- ALL EXCAVATIONS BELOW THE ROAD SHOULD BE BACK FILLED WITH CLASS 6F MATERIAL COMPACTED IN ACCORDANCE WITH TABLE 6.4 OF 600 SERIES OF THE SPECIFICATION FOR ROAD WORKS (TII).
- GEOTEXTILE TO BE ADDED IF REQUIRED UPON INSPECTION BY ENGINEER.

TABLE 1: CAPPING LAYER DEPTH

THE MINIMUM REQUIRED THICKNESS OF NON-FROST SUSCEPTIBLE CAPPING MATERIAL IS SHOWN HEREUNDER:

CBR SUBGRADE (%)	<2.5	2.5	3	4	5-15	>15
THICKNESS OF CAPPING LAYER (mm)	SPECIALIST GEOTECHNICAL ADVISE REQUIRED	600	350	300	250	150

CBR TESTS SHALL BE CARRIED OUT AT A RATE OF ONE TEST PER 100 METERS OF ROAD OR WHERE THE SOIL TYPE CHANGES.

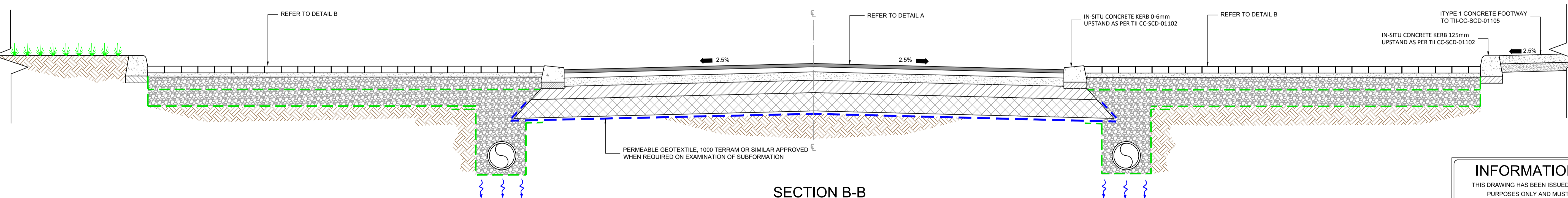
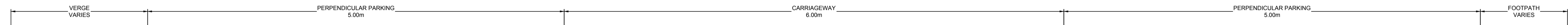
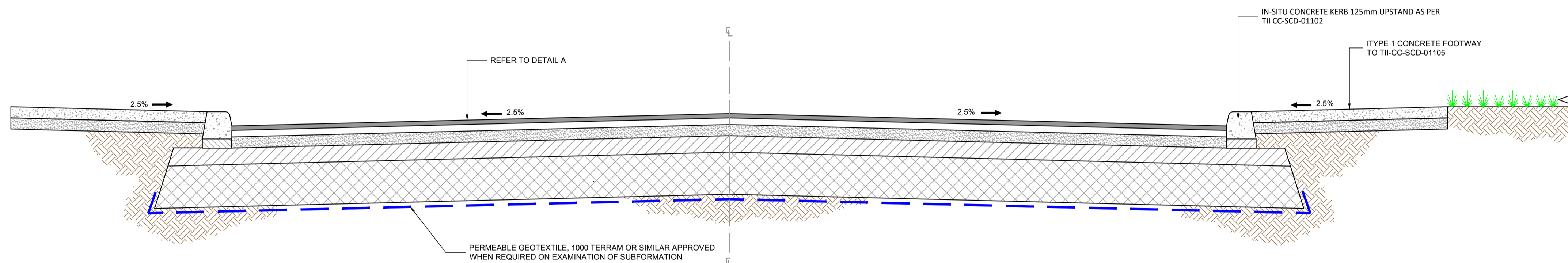
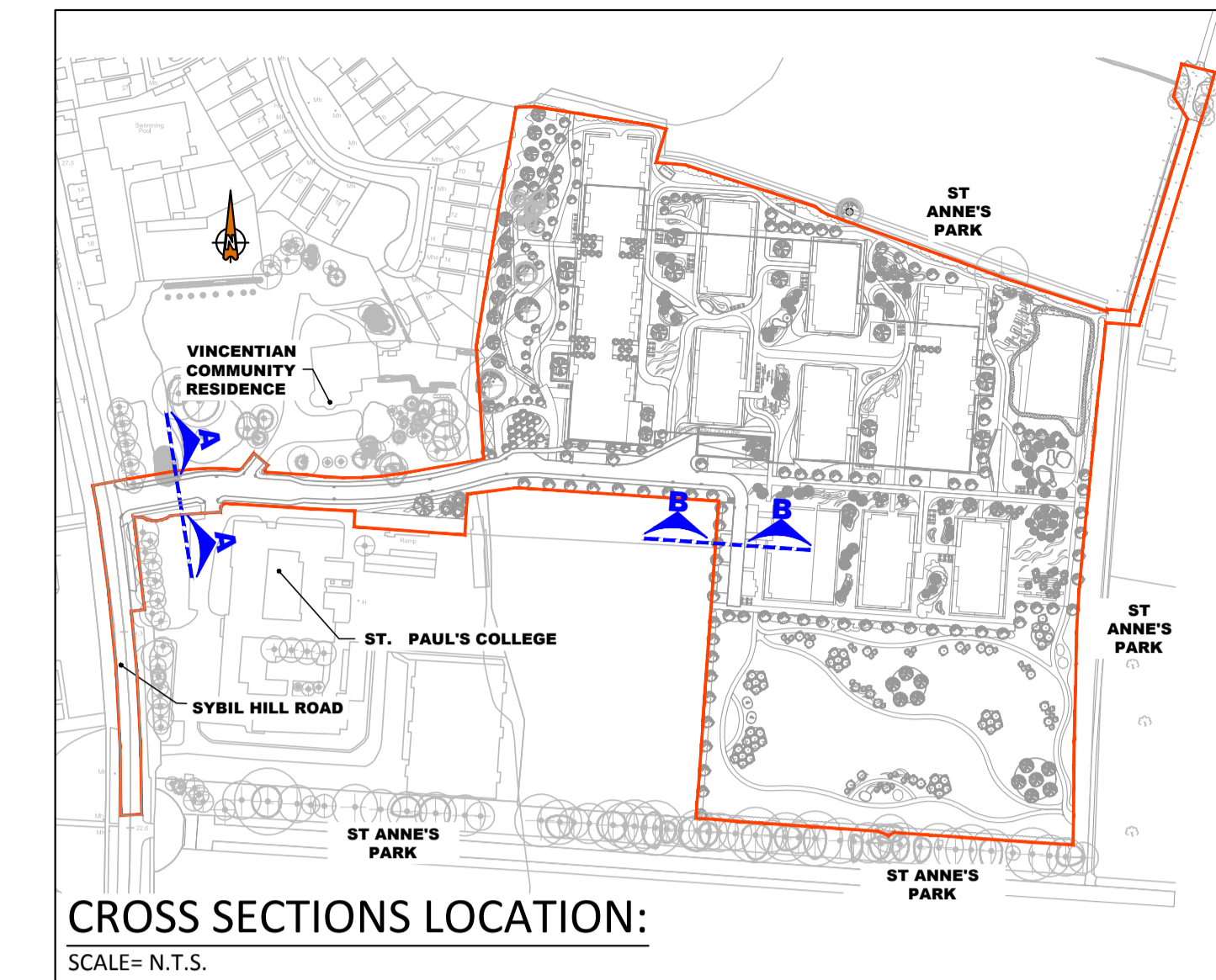

INFORMATION ONLY
THIS DRAWING HAS BEEN ISSUED FOR INFORMATION PURPOSES ONLY AND MUST NOT BE USED FOR CONSTRUCTION UNDER ANY CIRCUMSTANCES

NOTES

- For setting out refer to Engineer's drawings.
- This drawing to be read in conjunction with all other Engineering drawings and all other relevant drawings and Specifications.
- DO NOT SCALE THIS DRAWING. Use figured dimensions only.
- No part of this document may be reproduced or transmitted in any form or stored in any retrieval system of any nature without the written permission of O'Connor Sutton Cronin as copyright holder except as agreed for use on the project for which the document was originally issued.
- Ordnance Survey of Ireland licence no. EN0000817 © Government of Ireland

Rev. No.	Date	REVISION NOTE	Drn. By	Chkd. By
P1	14/08/2017	ISSUED FOR PLANNING	JS	AL
P2	15/12/2017	ISSUED FOR PLANNING	JS	JB
P3	16/05/2018	ISSUED FOR COMPLIANCE	SMC	PR
P4	12/04/2019	ISSUED FOR COMPLIANCE	AF	JS
P5	23/05/2019	ISSUED FOR PLANNING	AF	JB
P6	16/08/2019	WORKING IN PROGRESS	MC	JB
P7	30/08/2019	SUITABLE FOR INFORMATION	AF	JB
P8	13/09/2019	SUITABLE FOR INFORMATION	RB	JB
P9	30/09/2019	ISSUED FOR INFORMATION	MC	JB

Rev. No.	Date	REVISION NOTE	Drn. By	Chkd. By

OCSC
Multidisciplinary Consulting Engineers

O'Connor Sutton Cronin & Associates Ltd.
9 Frussia St., Dublin 7.

TEL +353 (0)1 8682000
FAX +353 (0)1 8682100
e: contactus@ocsc.ie
w: www.ocsc.ie

Client: Crekav Trading GP Limited.
Project: St. Paul's Residential Development.
Title: TYPICAL CROSS SECTIONS

Drn. By: JS
Chkd. By: AL
Appr. by: TH
Date: 15.12.17
Scale: 1:25 @ A1

Revision: P9

Office Locations | Dublin (Head Office) | London | Cork | Galway | Belfast | Warsaw | Bucharest | Moscow | Abu Dhabi | Libya |